



kiplingtours



Paris Tour - June 2018



Day 1 - 25 June

Meet at the school
06:00

Depart at 06:30



Eurotunnel

Depart Folkestone

10:20

Arrive Calais
11:55



Stop en-route at Thiepval - WW1 Commonwealth War Memorial



ecst
S.P.Q.R.

Status Paris Quality Resort

Localisation Campus Ouest & Est

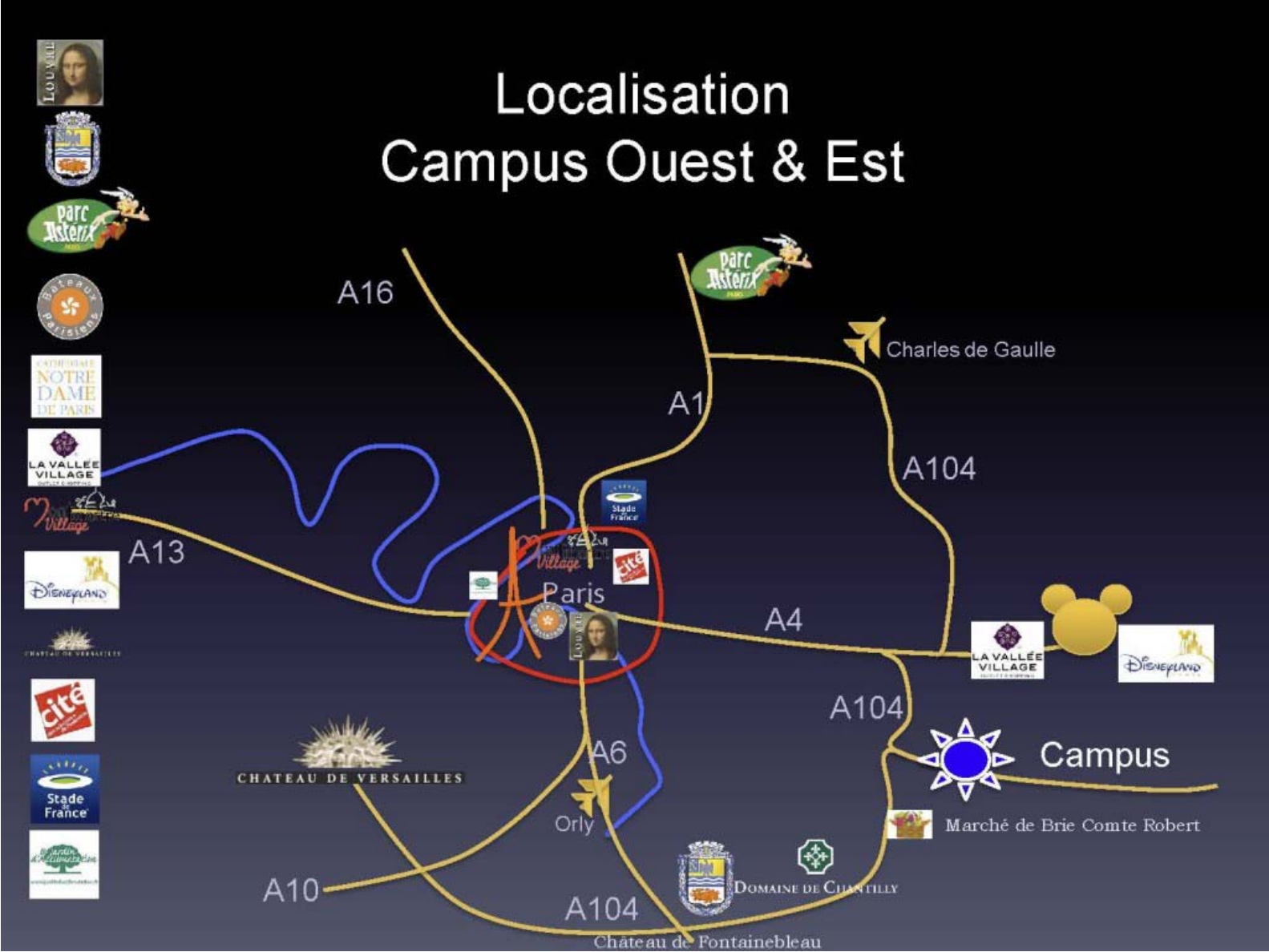

Education & Culture Sainte-Thérèse

Avenue Desiderius Erasme, Rond-point de l'Europe

CS 20294

77837 Ozoir-la-Ferrière CEDEX

Tél : +33 1 64 43 10 24

Fax : +33 1 64 43 10 17



Accommodation in Paris at European Campus St. Therese











Day 2 - 26 June 2018

- See the Eiffel Tower
- Bateaux Mouche cruise on the River Seine
- Montparnasse Tower
- Champs Elysees
- Arc de Triomphe
- Montmartre



River Seine Boat Trip Starting from the Eiffel Tower



Sail along the River towards Notre Dame Cathedral



Notre Dame Cathedral

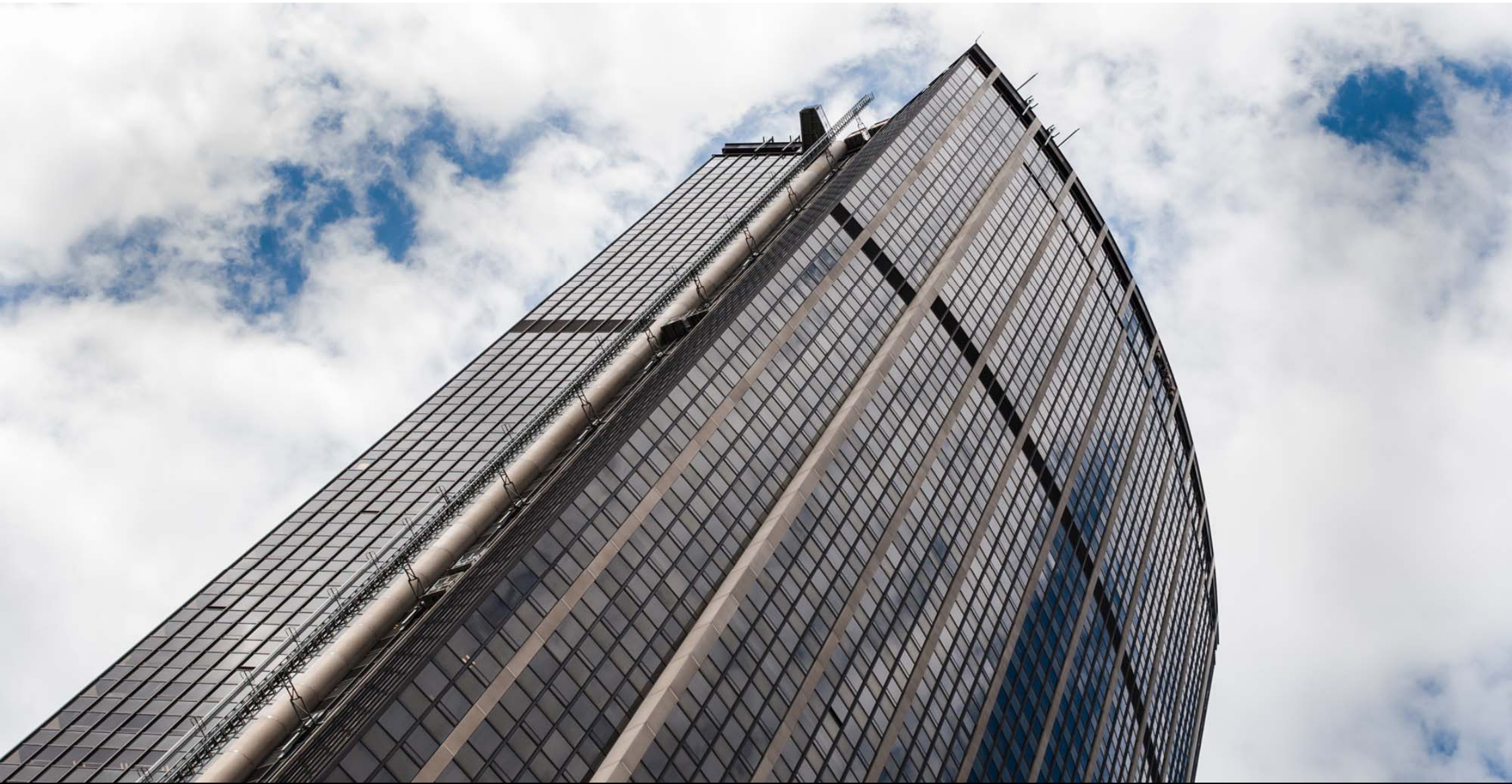

Transfer by coach to the Montparnasse Tower



Take the high speed lift to the top



The viewing deck has the best view in Paris



Specatcular view of the Eiffel Tower



Have lunch in the Tuileries Gardens



Walk along the Champs Elysees



Meet the coach at the Arc de Triomphe



Explore the Montmartre District



Visit Sacre Coeur



Explore the Montmartre District with its artists and cafes

Day 3 - 27 June 2018

- Snail farm visit
- Palace and gardens of Versailles



Visit a snail farm this morning



See the snails being collected



Tasting is optional !



After lunch, visit the Palace of Versailles

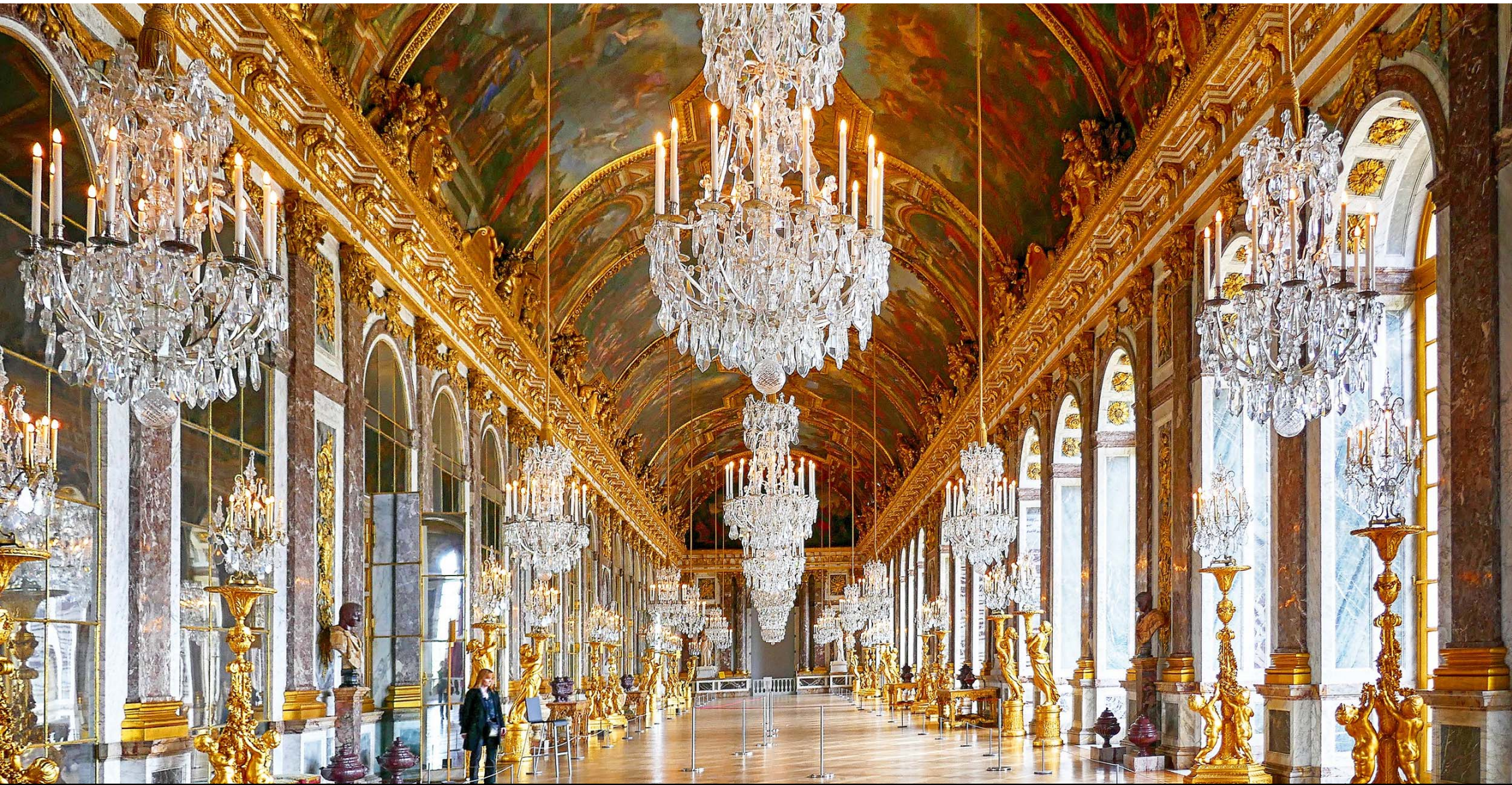

The spectacular Hall of Mirrors



The beautiful formal gardens

Day 4 - 28 June 2018

- Full day at Parc Asterix



parc
Asterix
PARIS



Full day at Parc Asterix



Lots of rides to choose from



A spectacular and exhilarating roller coaster

Day 5 - 29 June 2018

- Chocolate Factory Visit with Tasting and shopping opportunity in Compiègne

Eurotunnel

Depart Calais	18.20	(local time)
Arrive Folkestone	17.55	(UK time)
Arrive at School	21.00	Approximately

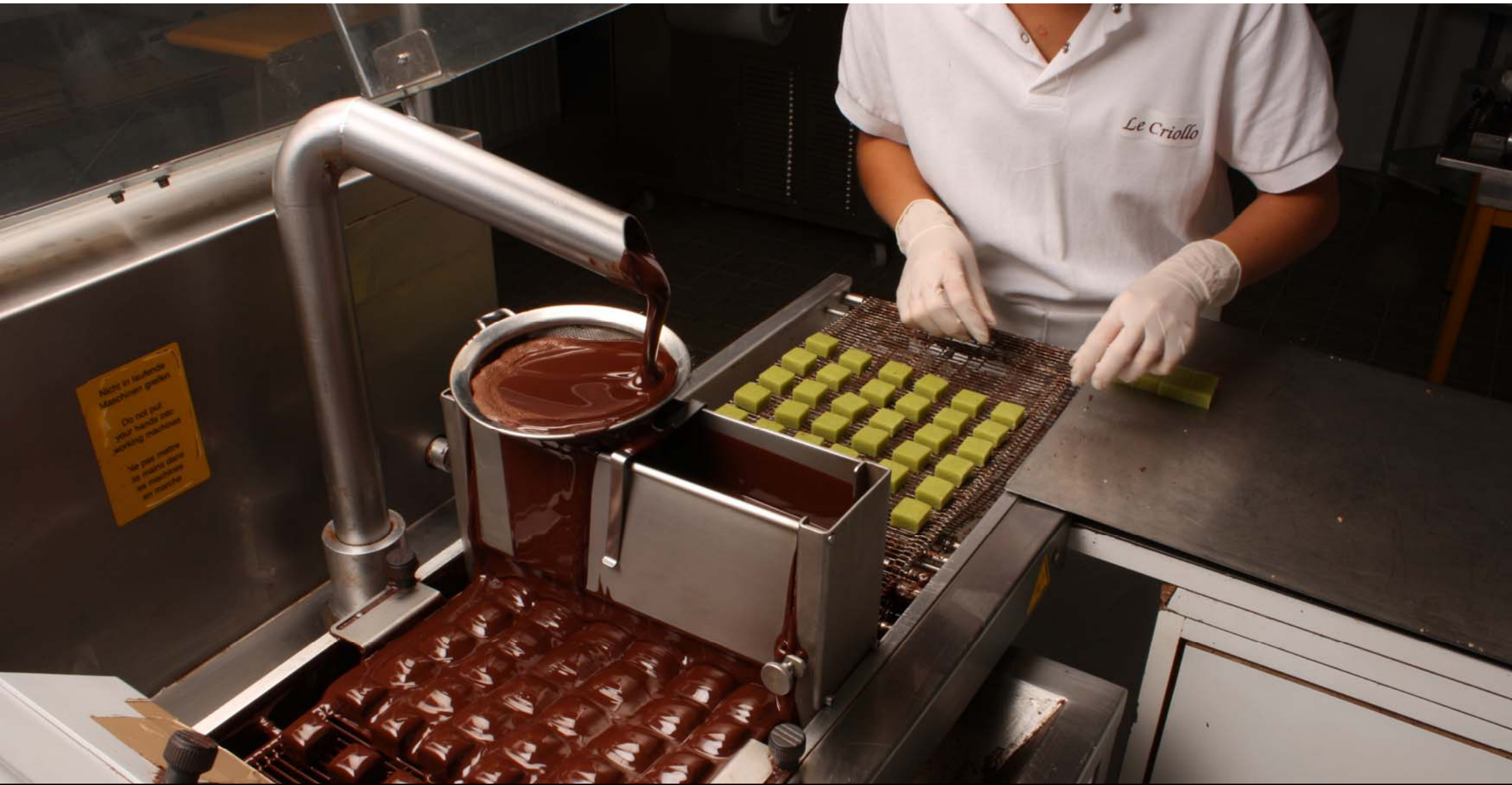

Visit a Chocolate Factory

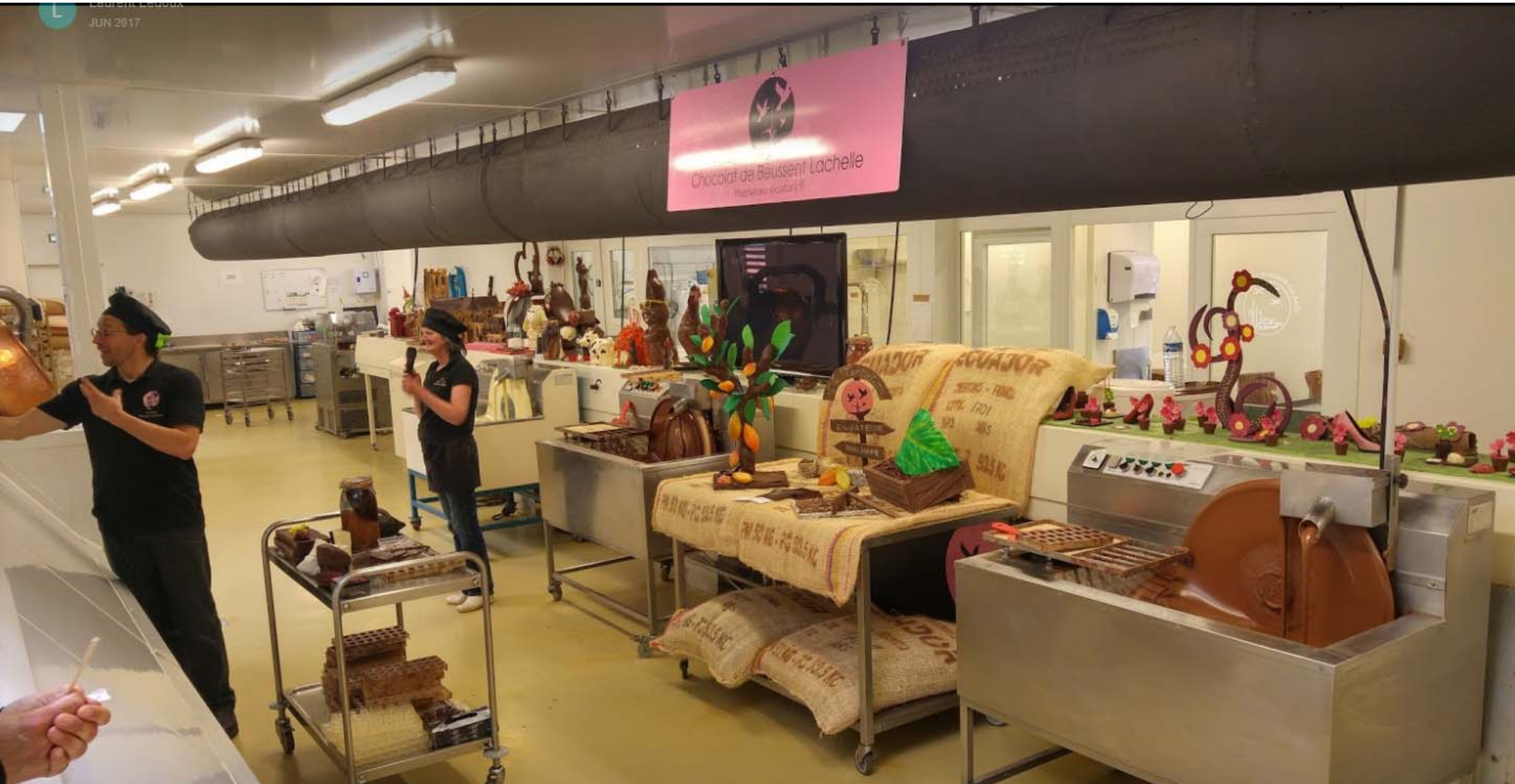

See the chocolate making process

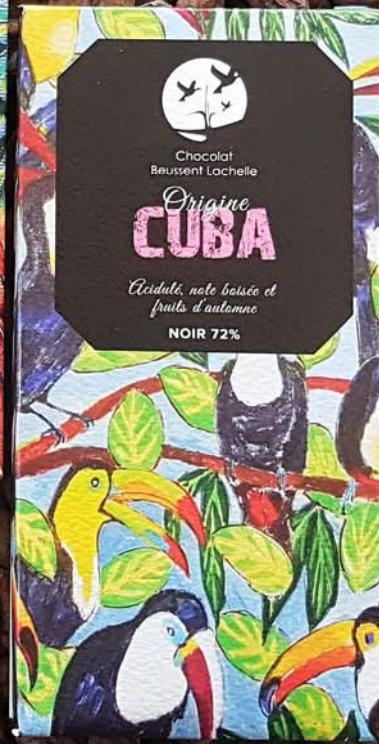
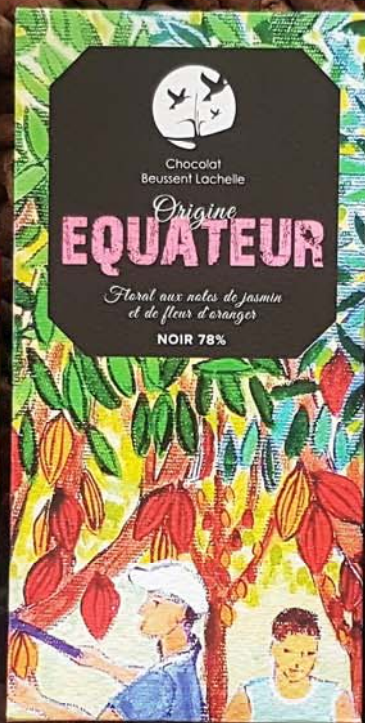
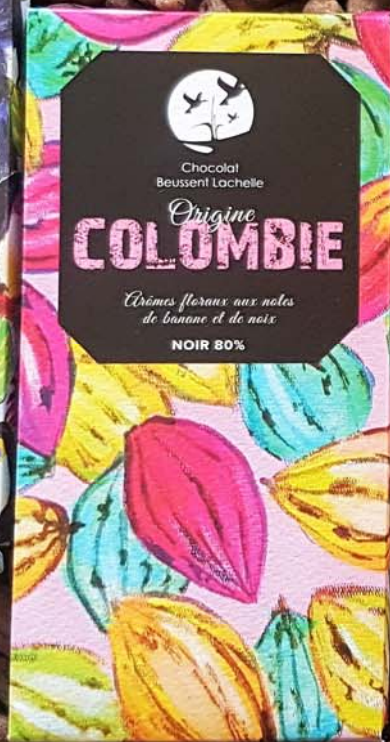

Sampling at the end!



The important info

No short shorts or crop tops

Mobile phones are only to be used for listening to music during coach journeys and as cameras

Mobile phones will be handed to group leaders at 10pm every evening.

All medicines to be handed in to group leaders together with passport and EHIC card before setting off. (meeting in the turning circle at 06:00)



What to bring

- Pocket money 50 Euros approx
- In-coach musical entertainment!
- Pen, pencil rubber etc.
- A pocket French dictionary
- Waterproof clothing
- Sun cream sunglasses & hat
- Suitable footwear for on-site activities ie rounders and walking around.
- Hairdryers
- Packed lunch for journey to France



Accommodation -

- Rooms sharing 3-4
- No mixed rooms
- Your son/daughter will complete a rooming slip tomorrow at the meeting at afternoon form time.
- I will endeavour to put the first choices together.



Résidences sud nord forêt Monde # ECST Est



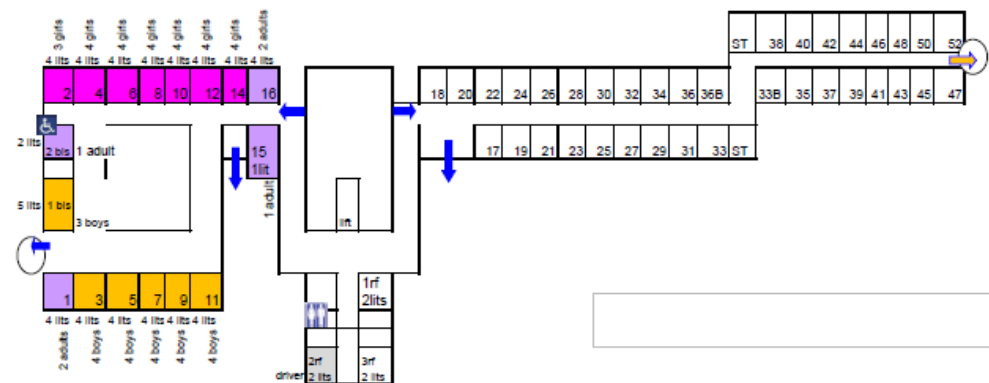







female	5
male	1
driver	1
girls	27
boys	23
guide	0
total	57



Trips Hoodies

Colours

This text will say
"Paris", but we were
unable to get this on
the preview

-  Burgundy
-  Candyfloss Pink
-  Bottle Green
-  Hawaiian Blue
-  Roval
-  Sunset Red
-  Sun Yellow
-  Jet Black
-  Ultra Violet
-  Burnt Orange



Order Form for Paris Trip Hoodies

Full Name.....

Form.....

Form Room.....

Paid:

S- To fit: 36 in	<input type="checkbox"/>
M - To fit: 40 in	<input type="checkbox"/>
L - To fit: 44 in	<input type="checkbox"/>
XL - To fit: 48 in	<input type="checkbox"/>
XXL - To fit: 52 in	<input type="checkbox"/>

I have enclosed a cheque for **£18** made payable to Mrs S Boschetti

Size – Please tick **ONE**



Specific Colour (please put full name of the colour from colour sheet!)

.....

Please hand these forms into the MFL office by **Friday 8th June**. Forms and cheques can also be handed in to Mrs Brooke at the trip meetings.

If you are unable to do this or have any questions or issues, please visit our form room (**IT4**) OR email

12barterl@roundwoodpark.co.uk or

12boschettif@roundwoodpark.co.uk